

Courses & distances down  
 Lycoming Creek  
 30 cuts 68 ps.  
 S. 42° E 38.  
 S. 4 1/2° N. 24.  
 S. 9 1/2° W 39.  
 S. 6 1/2° N. 28.  
 S. 24° W. 20.  
 S. 47 1/2° W 42 Beech.  
 S. 20° W 66. post of E. Burds.

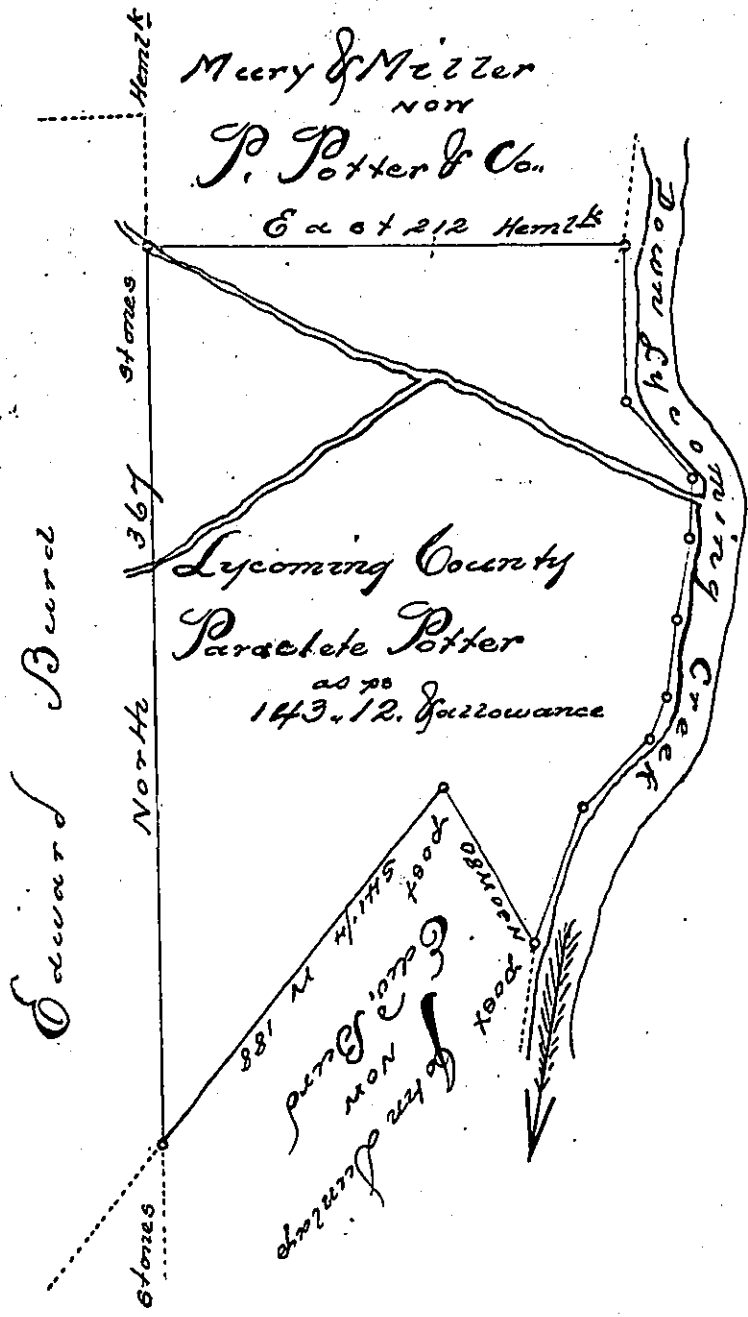

Survey'd the above described tract of Land on the fifth day of December  
 A. D. 1827, for Paradele Potter in pursuance of his warrant dated the 26<sup>th</sup>  
 of November A. D. 1827, Situate in Jackson Township Lycoming County  
 Containing One hundred & forty three acres, and twelve perches, and allowance  
 of six per Cent for Roads &c.

Gabriel Heister Esquire  
 Surveyor General  
 Harrisburgh

John A. Gamble A. J.

IN TESTIMONY that the above is a copy of the original remaining on file in  
 the Department of Internal Affairs of Pennsylvania, made  
 conformably to an Act of Assembly approved the 16th day of  
 February, 1833, I have hereunto set my Hand and caused  
 the Seal of said Department to be affixed at Harrisburg,  
 this seventh day of February 1899

James W. Latta  
 Secretary of Internal Affairs.